

**REVISIONS**

REV #	DATE	BY:
1	2/5/13	J.P.
2	2/14/13	J.P.
3	4/16/13	J.P.

Calculation Summary

Label	Units	Avg	Max	Min	Avg/Min	Max/Min	Footcandle	Footcandle
OVERALL SUMMARY	Fc	2.02	6.6	0.1	20.20	66.00	10	10

Illuminance schedule

Symbol	Qty	Label	Lumens	LF	Description
⊙	3	A	60000	0.850	WLS-8905-4-515-4M-FSMB-FG-V 30' POLE 2-4' MOUNTING HEIGHT
⊙	8	B	32000	0.800	WLS-8905-4-320-4M-FSMB-FG-V 20' POLE 2-4' BASE
⊙	12	C	34000	0.800	WLS-8905-4-320-4M-FSMB-FG-V 20' POLE 2-4' BASE

AS A RESULT OF THE COLOR OF THE LIGHT SOURCE (5000K, CRI-90+), THE "SEE-ABILITY" PRODUCED BY THIS LIGHTING SOLUTION WILL APPEAR AT LEAST 30% BRIGHTER THAN THIS PHOTOPIC MODEL SUGGESTS.

BASED ON THE INFORMATION PROVIDED, ALL DIMENSIONS AND LUMINAIRE LOCATIONS SHOWN REPRESENT RECOMMENDED POSITIONS. THE ENGINEER AND/OR ARCHITECT MUST DETERMINE APPLICABILITY OF THE LAYOUT TO EXISTING OR FUTURE FIELD CONDITIONS.  
THIS LIGHTING PATTERN REPRESENTS ILLUMINATION LEVELS CALCULATED FROM LABORATORY DATA TAKEN UNDER CONTROLLED CONDITIONS UTILIZING CURRENT INDUSTRY STANDARD LAMP RATINGS IN ACCORDANCE WITH ILLUMINATING ENGINEERING SOCIETY APPROVED METHODS. ACTUAL PERFORMANCE OF ANY MANUFACTURER'S LUMINAIRE MAY VARY DUE TO VARIATION IN ELECTRICAL VOLTAGE, TOLERANCE IN LAMPS AND OTHER VARIABLE FIELD CONDITIONS.

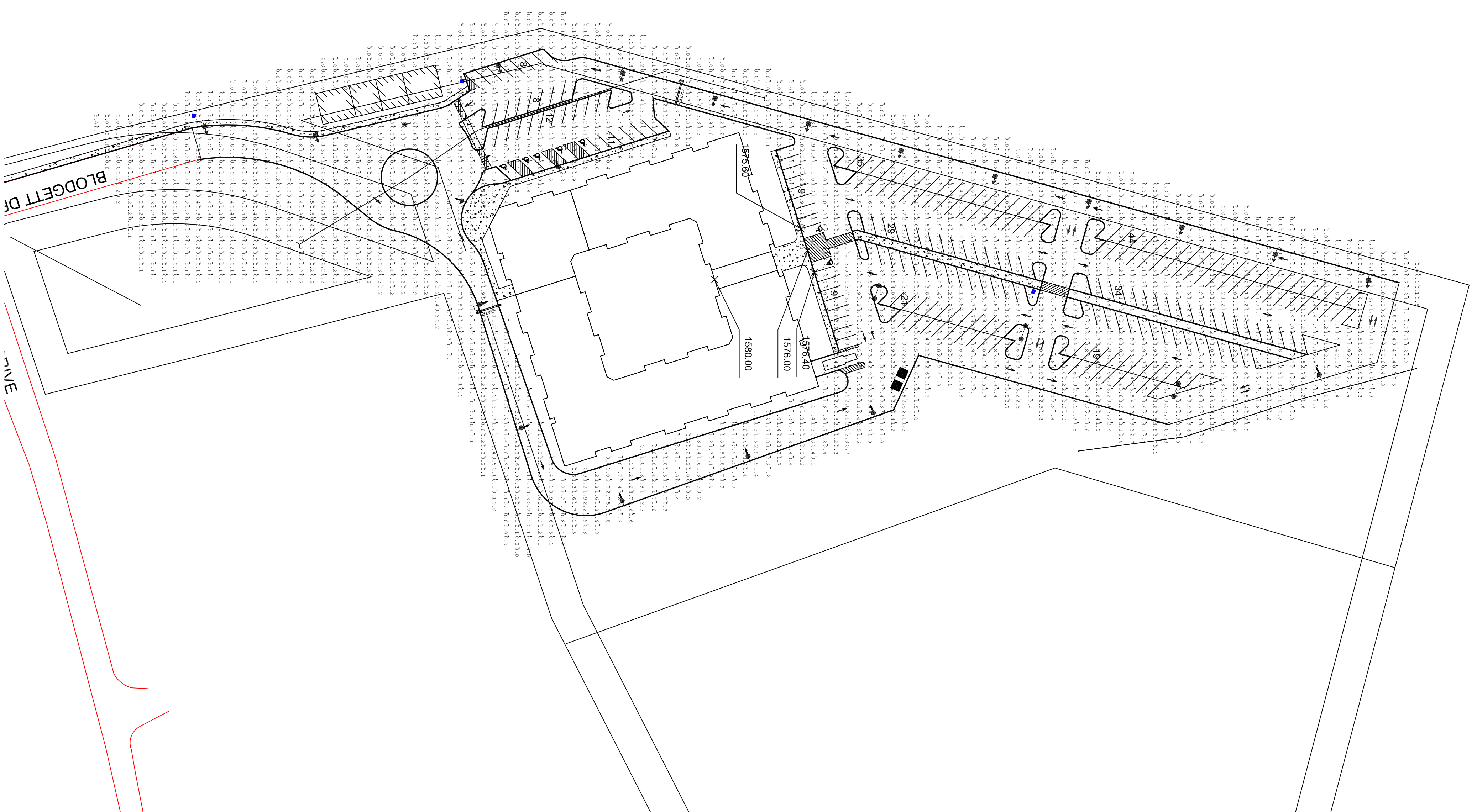

**HILLSIDE COMMONS  
ONEONTA, NY**



1919 WINDSOR PLACE  
FORT WORTH, TX 76110  
WWW.WLSLIGHTING.COM

WLS-8905

DATE - 1/31/13

SCALE: 1"=60'

800-633-8711

PM: STEVE

BY: J.P.

SHEET 1 OF 1